



WATCHLOG PRO Custom Cloud Monitoring

PLUG AND PLAY CLOUD MONITORING SYSTEM CONFIGURED TO YOUR SYSTEM



When integrated into your system, a Watchlog PRO Custom Cloud Monitoring unit will continuously transmit all connected sensor data to the cloud or by request to a custom web server via 4G (SIM card) or Wi-Fi.

View and save sensor readings using our online cloud platform, accessible via most web browsers. Configurable alerts are possible locally, utilising a light tower, buzzer or combination of both, and via notifications within the cloud software and SMS messaging.

Installed inline within your setup and powered by 12/24VDC or 240VAC, the Watchlog Pro Custom Cloud Monitor is the ultimate go-to for an existing or new sensor array. Depending on your requirement, a full range of sensor input options include Modbus, CAN bus, 4...20mA, 0...10V, RTD, Thermocouple K type and frequency. Switching outputs can optionally be included to control external equipment.

- Integrate the Watchlog Pro Custom Cloud Monitor directly into your existing system using the exterior power and sensor and switch connections.
- The integrated Watchlog Pro QUAD seamlessly transmits sensor data to the cloud and locally triggers buzzer and/or light tower alerts, if installed.
- Our powerful cloud platform allows sensor data to be monitored and logged in customisable dashboards and alerts, as well as sending SMS notifications for system events.

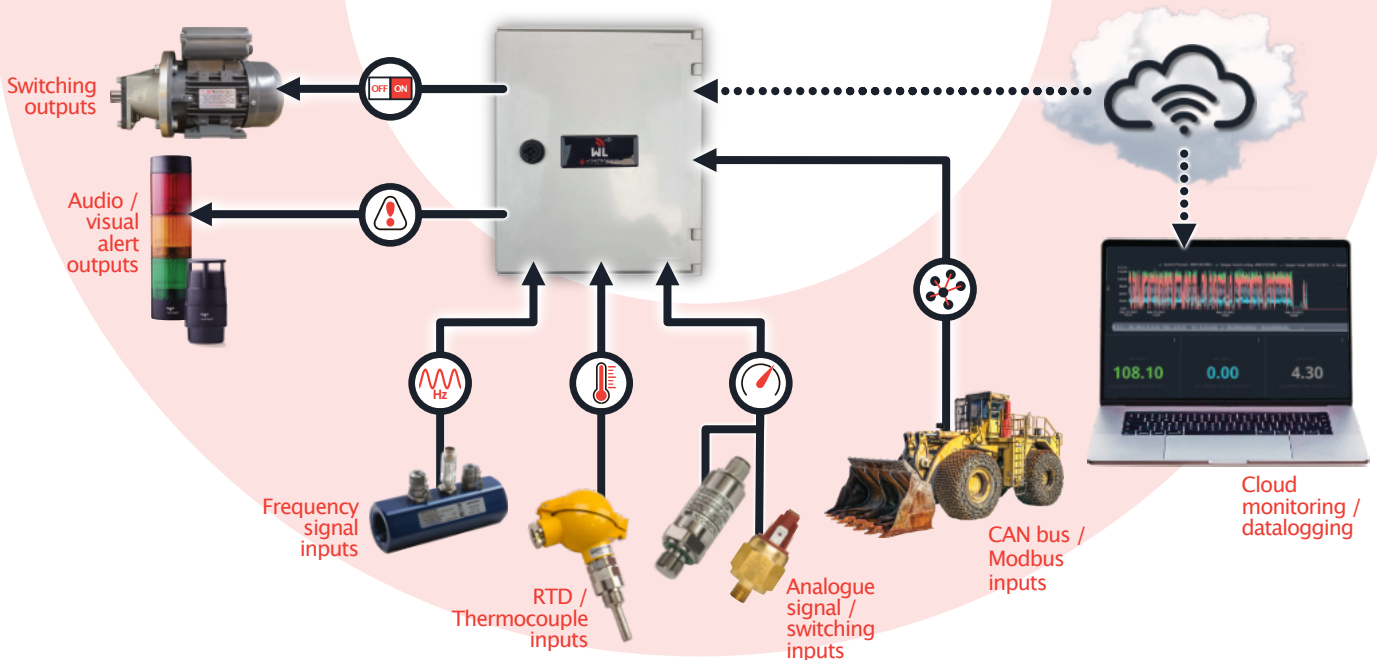



WATCHLOG PRO Custom Cloud Monitoring Features

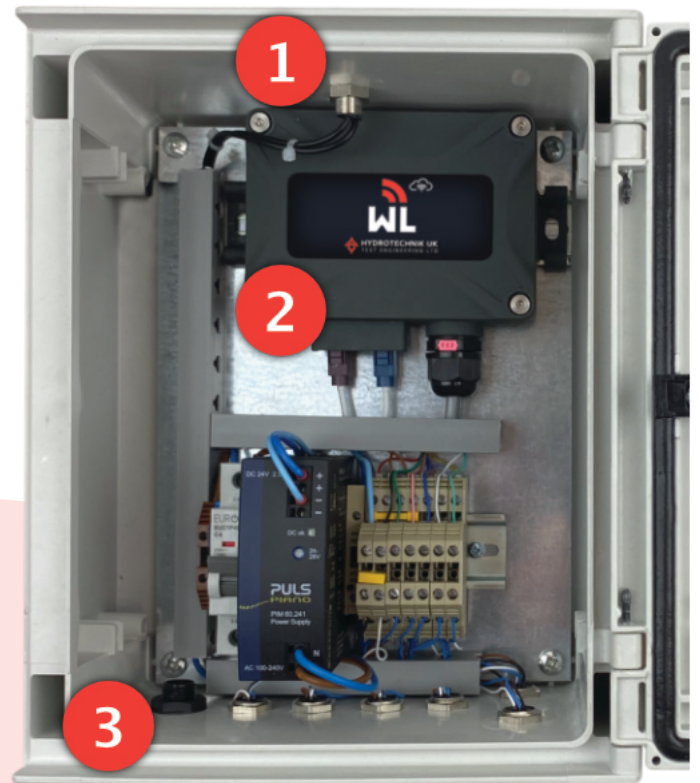

1

Robust Enclosure with external antenna

A rugged glass fibre reinforced polyester enclosure, built for industrial environments.

2

Watchlog Pro QUAD Cloud Gateway

The integral component of the unit, the Watchlog Pro QUAD, accepts all sensor data before transmitting it to the cloud via WiFi or 4G.

Local, configurable buzzer and/or light tower alerts are also triggered by the QUAD.



3

Input/Output connectivity built into the case

Easily connect your new or existing sensors to the cloud monitoring system using the integrated M12 connections on the bottom of the enclosure. K type thermocouple connections for temperature inputs are available when required.

Power, Modbus and CAN bus connections are included as standard. Analogue, digital, frequency and temperature inputs and switching outputs are provided to your requirements.





WATCHLOG PRO

Custom Cloud Monitoring

Technical Specifications

Power	External supply: 12/24VDC or 240VAC	
Channel signal options	Analogue inputs	4 or 8x 4...20mA 4 or 8x 0-10V
	Temperature inputs	4 or 8x RTD 4 or 8x Thermocouple
	Frequency inputs	Up to 4
	Switch outputs	Up to 4
Channel connectivity	Female M12 for all input and output channels, except Thermocouple which use K type Thermocouple and CAN bus which uses Male M12	
Internal sensors	GPS, Accelerometer for pitch, roll and vibration Ambient temperature, and voltage monitoring	
Monitoring	Use the Watchlog Portal to view and store data and configure and update devices Optional SMS notifications	
Buzzer volume	95db	
Network	4G LTE CAT-M1 (QUAD-C2-G) / 4G LTE CAT-1 (QUAD-C2-H) SIM card holder for Micro-SIM (internal soldered SIM optional) Wi-Fi (QUAD-C2-W) Endpoint: Watchlog Portal and 3rd party MQTT(S), HTTP(S), UDP servers	
Mechanical	Number of channels*	Dimensions
	8 or less	Width: 250mm, Height: 300mm, Depth: 140mm Height with Antenna: 317.5mm Height with Buzzer: 394mm Height with Light Tower: 462mm Light tower radius: \varnothing 50mm
	More than 8	Width: 300mm, Height: 400mm, Depth: 200mm Height with Antenna: 417.5mm Height with Buzzer: 494mm Height with Light Tower: 562mm Light tower radius: \varnothing 50mm

*Number of channels excludes power, CAN bus and Modbus which are included as standard.



WATCHLOG PRO

Custom Cloud Monitoring

Ordering Code

Use the following lookup tables to create an order code for your requirement.

WLPROQ - XX - AI - TI - FI - SO - Z

Replace XX with	Power input
AC	240 VAC
DC	12/24 VDC

Replace AI with	Analogue inputs
A0	None
I4	4x 4...20mA
I8	8x 4...20mA
U4	4x 0...10V
U8	8x 0...10V

Replace TI with	Temperature inputs
T0	None
R4	4x RTD input
R8	8x RTD input
T4	4x Thermocouple input
T8	8x Thermocouple input

Replace Z with	Alert option
X	None
W	Buzzer
Y	Red & Green light tower
Z	Buzzer and Red & Green light tower

Replace SO with	Switch outputs
S0	None
S1	1 output
S2	2 outputs
S3	3 outputs
S4	4 outputs

Replace FI with	Frequency inputs
F0	None
F1	1 input
F2	2 inputs
F3	3 inputs
F4	4 inputs

See next page for ordering examples.



WATCHLOG PRO

Custom Cloud Monitoring Ordering Examples

Example 1: WLPROQ-AC-I4-T0-F0-S0-W



- AC:** 230VAC power
 - I4:** 4x 4...20mA analogue inputs
 - T0:** No temperature inputs
 - F0:** No frequency inputs
 - S0:** No switch outputs
 - W:** Local Buzzer (not shown)
- Modbus and CAN bus as standard
≤8 channels: 250x300x140mm enclosure

Example 2: WLPROQ-DC-I4-T0-F2-S2-X



- DC:** 12/24VDC power
 - I4:** 4x 4...20mA analogue inputs
 - T0:** No temperature inputs
 - F2:** 2x frequency inputs
 - S2:** 2x switch outputs
 - X:** No local alerts
- Modbus and CAN bus as standard
≤8 channels: 250x300x140mm enclosure

Example 3: WLPROQ-DC-I4-U4-T0-F0-S2-W

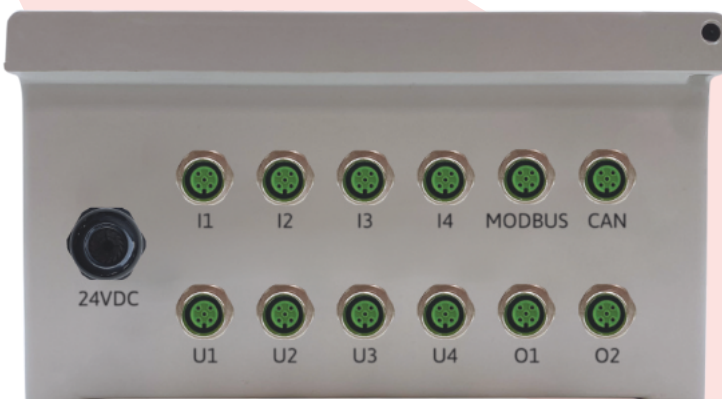

- DC:** 12/24VDC power
 - I4:** 4x 4...20mA analogue inputs
 - U4:** 4x 0...10V analogue inputs*
 - T0:** No temperature inputs
 - F0:** No frequency inputs
 - S2:** 2x switch outputs
 - W:** Local Buzzer (not shown)
- Modbus and CAN bus as standard
≥8 channels: 300x400x200mm enclosure

*Example 3 includes an additional set of analogue inputs which may be added after the first set, if required.