

Minimes gas charging valves & adaptors

**MINIMESS®-gas charging valve 1615**

Maximum working pressure 63 MPa

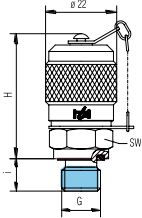

**Screw-cap thread:**  
M 16 x 1,5

**Compatible with the following media**

Inert gases, nitrogen and compressed air. Resistant against antifreeze, oil, anti corrosion oil, grease and fuel.

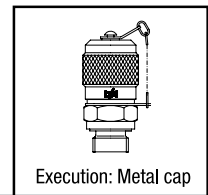
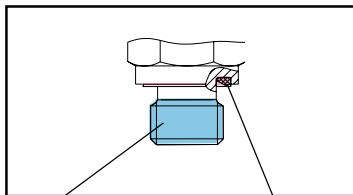

Execution: Metal cap

Thread G	Type of sealing A	Torque in Nm	p max Bar	H mm	i mm	SW mm	Operating temperature range	Coupling material	Part number with FKM sealing
1/2"-20 UNF	Form F	30	63MPa	36,5	9	19	-20 °C bis +135 °C	1.4104	2402-01-26.00
M 14 x 1,5		40		36,5	10	19			2402-01-14.00
ISO 228-G 1/4		40		36,5	10	19			2402-01-18.00

Recorded with inspection certificate 3.1 B in accordance to DIN EN 10204, certificate 2.2. in accordance to DIN EN 10204

M 14 x 1,5	Form B	40	63 MPa	36,5	10	19	-33 °C bis +135°C	1.4104	2402-01-49.70
------------	--------	----	--------	------	----	----	-------------------	--------	---------------

**Material**

Body: 1.4104 (C4)  
Pressure spring: 1.4310  
Screw cap: brass (blackened)

**Sealing**

Internal primary and secondary sealing as well as integral seat seal and anti vibration O-ring (to prevent loosening of the metal cap) made of Viton.

**Attention: Before using oxygen, please ensure you rinse and clean the gas charging valve.**

**Adapter incorporating gas charging valve 1615 made of stainless steel**

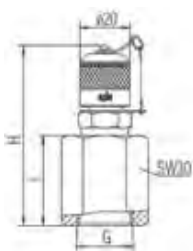

Thread of accumulator	Type of hydraulic accumulator	p max Bar	Material	H mm	i mm	SW mm	Part number with FKM sealing
7/8"-14 UNF	Bosch-bubble accumul.	63MPa	1.4104	73	36	30	2446-16-30.00
M 28 x 1,5	Bosch-diaphragm accumul.			63	26	36	2446-18-30.00

**Gas charging valve adapter 1615**

To be directly screwed on the original valve of the accumulator

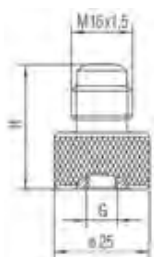

Thread of accumulator	Type of hydraulic accumulator	p max Bar	Material	H mm	Part number with FKM sealing
VG 8 DIN 7756	Langen	63MPa	1.0718	32	5414-02-00.00
5/16"-32 UNEF	US			32	5414-02-10.00