

High Temperature Pressure Transducers & Transmitters

HT-SKE Series

- 
- High accuracy & reliability
 - Ranges 1 bar to 2,000 bar
 - 2/3 wire 4-20mA & voltage
 - Wide choice of connectors
 - Temperature 180°C/200°C
 - Compact and rugged design

For applications with high media temperatures up to 180°C or even 200°C, the HT-SKE pressure sensor features a dry silicon technology pressure sensor and remote electronics package with Teflon interconnecting cable. This configuration enables direct contact with pressure media and precise measurements, even at extreme levels of thermal loading.

Plant Engineering
Industrial Machinery
Chemical & Process
Hydraulics and Pneumatics
Automotive

High Temperature Pressure Transducers & Transmitters

HT-SKE Series

TECHNICAL SPECIFICATIONS

Standard pressure ranges & signal outputs

Measuring range *(bar)	1	1.6	2	2.5	4	6	10
Overload pressure	6	6	6	6	10	20	20
Burst pressure	9	9	9	9	15	30	30
Measuring range (bar)	16	20	25	40	60	100	160
Overload pressure	40	40	100	100	200	200	400
Burst pressure	60	60	150	150	300	300	600
Measuring range (bar)	200	250	400	600	1000	1600	2000
Overload pressure	400	750	750	840	1200	2400	2500
Burst pressure	600	1000	1000	1050	1500	3000	3000

*Gauge ranges shown - vacuum ranges available on request

Electrical	2 wire / 3 wire	3 wire	3 wire	ratiometric
Output signal	4-20mA	0-10Vdc	0-5Vdc	0.5-4.5Vdc
Supply voltage	9-32Vdc	12-32Vdc	8-32Vdc	5Vdc ± 10%

- Media temperature range:
-40°C to +180°C
Optional 200°C maximum
- Compensated temperature range:
-20°C to +85°C
- Ambient temperature range:
-40°C to +105°C

Performance

- Accuracy: Non-linearity, hysteresis and non-repeatability at room temperature according to IEC 61298-2 (or BSFL/Best Fit Straight Line): <1% FS range (<0.5% BSFL)
- Temperature effects: Zero/Span typical thermal coefficients: <0.15% FS range/ 10°C
- Total Error Band: 2% FS from room temperature to -40°C or +105°C
- Long term stability: <0.1% FS range/year
- Response time: <1ms (from 10% to 90% FS range)
- Vibration resistance: 20g (according to IEC 68-2-6 and IEC 68-2-36)
- Shock resistance: 1000g (according to IEC to 68-2-32)

Physical

- Material: body - stainless steel, pressure inlet port - stainless steel
- Process connection: G 1/4A, G 1/4B, G 1/2B, 1/4 NPT
- Other connections available on request
- Electrical connection: Integral PTFE cable with remote temperature compensation/electronics package and male socket e.g. M12 x 1 connector
Other connections available on request
- Weight: approximately 120g (dependent upon configuration)
- Ingress protection: IP65 (for connector versions with their mating plug fitted)

Options

- (1) higher media temperature <200°C max
- (2) additional cable (per metre/specify length)

For further options or customised products please contact us.

Related products

Hydrotechnik manufactures a wide range of sensors, test and measurement equipment.

Contact us for further information or visit www.hydrotechnik.co.uk

Continuing development can necessitate specification changes without notice

Dimensions

HT-SKE with M12x1 connection

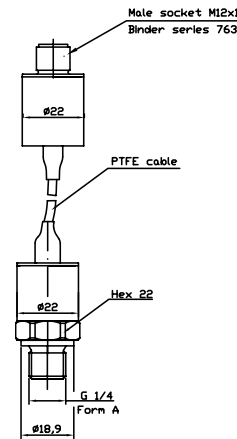

Mechanical Connections

G 1/4 A; DIN 3852; Form E 1/4 NPT

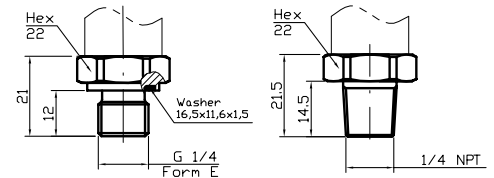

G 1/4 B

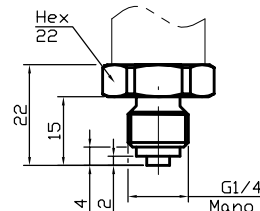

G 1/2 B

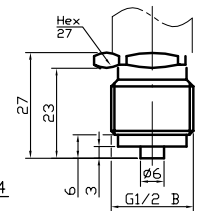

Electrical Connections

Male socket
M12 x 1 (S763)

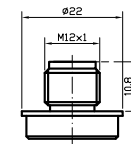

HT-SKE Series ORDER CODES

Series	Output Signal	Pressure Range	Unit	Pressure Type	Process Connection	HEX	Electrical Connection	Extras
HT-SKE	20.4	0010000	KGC	(sr)	G14B	22	M18	R06

4 ... 20 mA / 2 wires	10.0
0 ... 20 mA / 3 wires	10.1
4 ... 20 mA / 3 wires	10.2
0 ... 10 V	20.0
1 ... 5 V	20.1
0 ... 6 V	20.20
0 ... 5 V	20.4
0.5 ... 4.5 V ratiom.	37.0
0.5 ... 4.5 V non rat.	40.0
CANopen 2.0A	60.0
Others	AAA

bar	BAR
kPa	KPA
MPa	MPA
PSI	PSI
kg/cm2	KGC
m WC	MWS
in WC	IWS
others	CCC

Relative Pressure	(g)
Sealed Reference	(sr)

- I ... 0	9000100		
- I ... +1	9000900		
0 ... 1.0	0001000	0 ... 10	0010000
0 ... 1.6	0001600	0 ... 16	0001600
0 ... 2.0	0002000	0 ... 20	0002000
0 ... 2.5	0002500	0 ... 25	0002500
0 ... 4	0004000	0 ... 40	0004000
		0 ... 100	0010000
		0 ... 160	0016000
		0 ... 200	0020000
		0 ... 250	0025000
		0 ... 400	0040000
		0 ... 600	0060000
		0 ... 1000	0100000
		0 ... 1600	0160000
		0 ... 2000	0200000
		Others	BBB

G 1/8 A Shape A	G18A	22
G 1/4 A Shape A	G14A	22
G 1/4 A Shape E	G14E	22
G 1/4 B (Manom.)	G14B	22
G 1/2 B (Manom.)	G12B	22
G 1/2 A Shape E	G12E	27
1/8 NPT	I8NP	22
1/4 NPT	I4NP	22
7/16-20 UNF-2A	U72M	22
7/16-20 UNF-2A/2C	U72C	22
7/16-20 UNF-2B	U72F	22
3/8-24 UNF-2A	U38M	22
3/8-24 UNF-2A/C	U38C	22
1/2-20 UNF-2A	U12M	22
M 8x1 Shape A	M08M	22
M 10x1 Shape A	M10A	22
M 12x1 Shape E	M12E	22
M 12x1 Konical	M12C	22
M 12x1.5 CT-Ring	M12S	22
M 14x1.5 Shape A	M14A	22
M 14x1.5 Shape E	M14E	22
M 14x1.5 ISO	M140	22
M 16x1.5 Shape A	M16A	22
M 16x1.5 female	M16F	22
M 18x1.5 male	M18M	22
M 20x1.5 Manom.	M20B	22
R 1/4 male	RI4M	22
Others	DDDD	EE

MVC/A	MVA
MVC/C	MVC
Hirschmann Mini	HIM
LEMO EWB IS	LMS
IS9 Industrial Socket	IS9
Packard	PAI
Male Socket M 5 / S707	M05
Male Socket M 12 / S763	M12
Male Socket M 16 / S723	M16
Male Socket M 18 / S714	M18
Junior Timer	JTI
Bajonet DIN 72585	BJD
Bajonet VG 95234	BJV
Super Seal	SUS
Deutsch 3-poles	D03
Deutsch 4-poles	D04
QUICK ON	QON
Flying Leads 1.0*	FLI
Cable Gland Plastic	CPI
Cable Steel 1.0*	KSI
Cable Plastic 1.0*	KPI
Others	FFF

* e.g. with cable length 1 metre

Restrictor 0.6 mm	RO6
Restrictor others	RXX
Total Error Other	FXX
Cleaned for Oxygen Use	O2C
Metal Cone	SC0
Schrader Opener 2.9	S29
Others (see below).	GG